



**Grove Road**

The Mounts, Northampton

**oriordanbond**  
SALES & LETTINGS



GROUND FLOOR  
333 sq.ft. (30.9 sq.m.) approx.

FIRST FLOOR  
331 sq.ft. (30.8 sq.m.) approx.

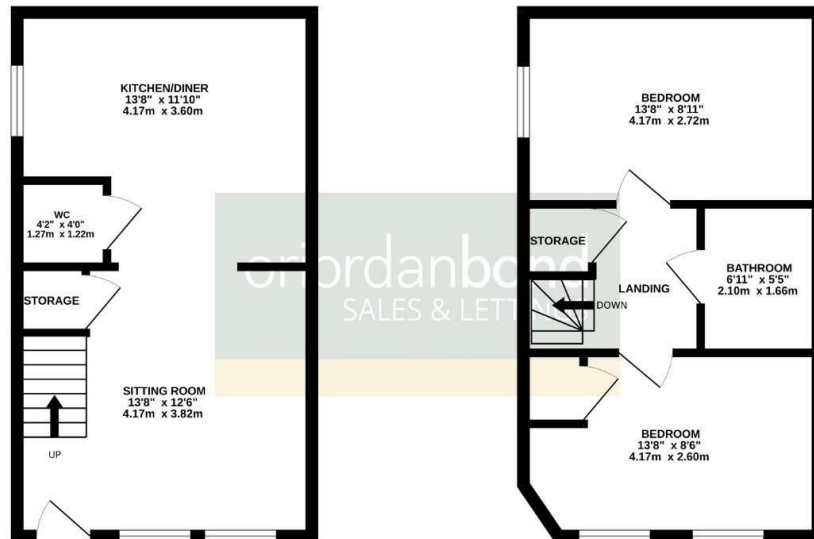

TOTAL FLOOR AREA : 664 sq.ft. (61.7 sq.m.) approx.

Whilst every attempt has been made to ensure the accuracy of the floorplan contained herein, measurements of doors, windows, rooms and any other items are approximate and no responsibility is taken for any error, omission or mis-statement. This plan is for illustrative purposes only and should be used as such by any prospective purchaser. The services, systems and appliances shown have not been tested and no guarantee as to their operability or efficiency can be given.  
Made with Metagap C2025

## Grove Road

The Mounts

NN1 3LQ

OFFERS OVER £160,000

Offered for sale with no onward chain is this two double bedroom end terraced house within walking distance to the town centre the town centre and general hospital as well as good road links to the train and bus station. The property is ideal for first time buyers or buy-to-let investment.

Accommodation comprises entrance into the sitting room open to a fitted kitchen/dining room, cloakroom/WC, two first floor double bedrooms and a three-piece bathroom suite. Benefits include uPVC double glazing, gas radiator heating and a communal rear garden. (B/664/com)

### Additional information

- Council Tax Band: A
- Energy Efficiency Rating: D

### Viewing

Viewing strictly by appointment – details below

### Disclaimer

O'Riordan Bond Estate Agents Limited has not tested apparatus, equipment, fittings or services and so cannot verify they are in working order. The buyer is advised to obtain verification from their solicitor or surveyor.

O'Riordan Bond Abington Sales  
01604 639007

abington@oriordanbond.co.uk

